

Q: How many screws and what kind of screws do I need to mount my pegboard?

A: It is advisable to follow the chart below in which incorporates two different kinds of screws (see fig. A) depending on what size of pegboard you purchased.

 #700109  #700107

8" X 20"

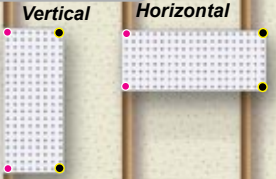

16" X 20"

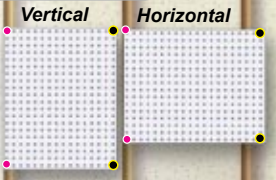

13.5" X 22"

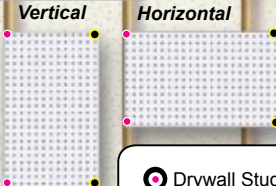

13.5" X 60"

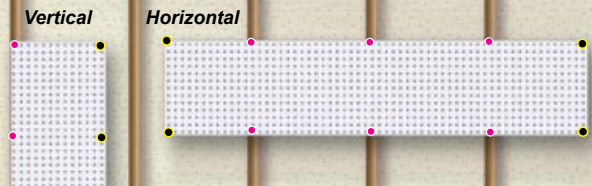

16" X 60"

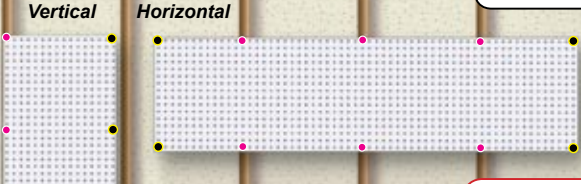

24" X 48"

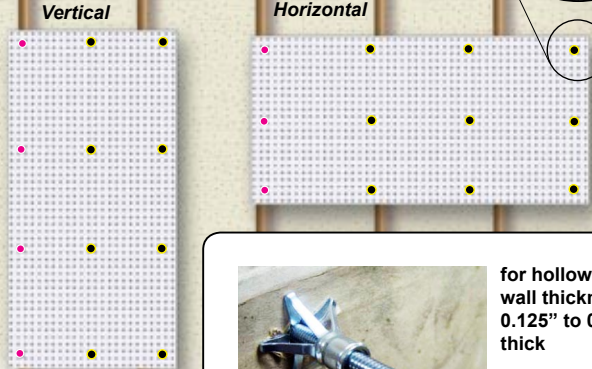
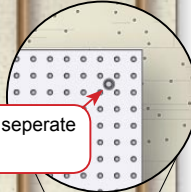
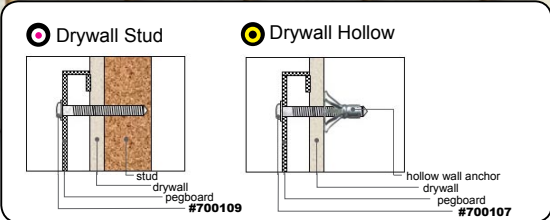

fig. A
#700107
 Expanding Hollow wall anchor screw

#700109
 Standard 1 3/4" screw

24" X 48" pegboard has a separate mounting hole for screws

for hollow wall thickness 0.125" to 0.500" thick

Use projection rods to suspend your wall panel 3"- 5" from the mounting surface.

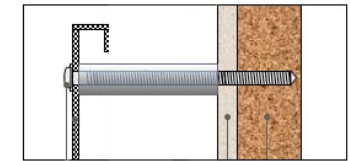
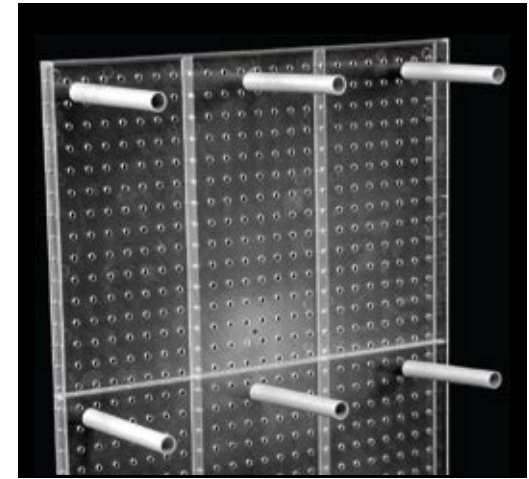

#700103
 3" Projection rods Set of 12 (includes screws)



#700105
 5" Projection rods Set of 12 (includes screws)

